

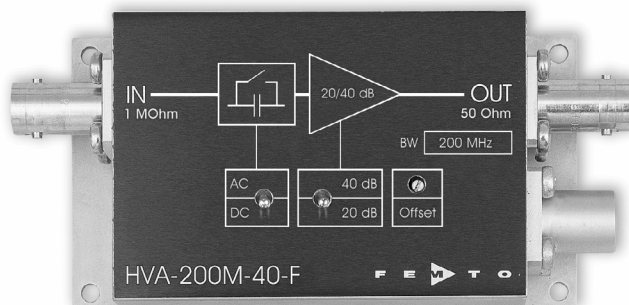

Datasheet

HVA-200M-40-F

200 MHz High Input Impedance Voltage Amplifier



Features	<ul style="list-style-type: none"> • Switchable Gain 20/40 dB (x10 / x100) • Bandwidth DC ... 200 MHz • High Input Impedance 1 MΩ • Switchable AC/DC Coupling 																																														
Applications	<ul style="list-style-type: none"> • Oscilloscope and Transient Recorder Preamplifier • Photomultiplier and Microchannel Plate Amplifier • Signal Booster for Optical Receivers and Current Amplifiers • Time-Resolved Pulse and Transient Measurements 																																														
Specifications	<table border="0"> <tr> <td></td> <td><i>Test Conditions</i></td> <td><i>V_s = ± 15 V, T_a = 25°C</i></td> </tr> <tr> <td rowspan="2">Gain</td> <td>Gain</td> <td>20/40 dB switchable</td> </tr> <tr> <td>Gain Accuracy</td> <td>± 0.2 dB</td> </tr> <tr> <td rowspan="3">Frequency Response</td> <td>Lower Cut-Off Frequency (-3 dB)</td> <td>DC/1 Hz switchable</td> </tr> <tr> <td>Upper Cut-Off Frequency (-3 dB)</td> <td>200 MHz</td> </tr> <tr> <td>Rise/Fall Time (10% - 90%)</td> <td>1.8 ns</td> </tr> <tr> <td rowspan="6">Input</td> <td>Input Impedance</td> <td>1 MΩ 15 pF</td> </tr> <tr> <td rowspan="2">Input Voltage Noise</td> <td>4.5 nV/√Hz (@ 50 MHz, 40 dB gain)</td> </tr> <tr> <td>5.5 nV/√Hz (@ 50 MHz, 20 dB gain)</td> </tr> <tr> <td rowspan="2">Intregated Input Noise</td> <td>450 μV peak-peak (@ 40 dB gain)</td> </tr> <tr> <td>600 μV peak-peak (@ 20 dB gain)</td> </tr> <tr> <td>Input Bias Current</td> <td>10 pA</td> </tr> <tr> <td>Input Offset Voltage</td> <td>500 μV typ.</td> </tr> <tr> <td>Input Voltage Drift</td> <td>5 μV/°C</td> </tr> <tr> <td rowspan="5">Output</td> <td>Output Impedance</td> <td>50 Ω (terminate with 50 Ω load for best performance)</td> </tr> <tr> <td>Output Voltage</td> <td>± 1 V (@ 50 Ω load, for linear amplification)</td> </tr> <tr> <td>Max. Output Current</td> <td>60 mA</td> </tr> <tr> <td>Output Offset Trimmer Range</td> <td>± 100 mV</td> </tr> <tr> <td>Slew Rate</td> <td>600 V/μs (@ 20 dB, 50 Ω load) 1,100 V/μs (@ 40 dB, 50 Ω load)</td> </tr> <tr> <td rowspan="2">Power Supply</td> <td>Supply Voltage</td> <td>± 15 V</td> </tr> <tr> <td>Supply Current</td> <td>± 70 mA typ. (depends on operating conditions, recommended power supply capability min. ± 150 mA)</td> </tr> </table>		<i>Test Conditions</i>	<i>V_s = ± 15 V, T_a = 25°C</i>	Gain	Gain	20/40 dB switchable	Gain Accuracy	± 0.2 dB	Frequency Response	Lower Cut-Off Frequency (-3 dB)	DC/1 Hz switchable	Upper Cut-Off Frequency (-3 dB)	200 MHz	Rise/Fall Time (10% - 90%)	1.8 ns	Input	Input Impedance	1 MΩ 15 pF	Input Voltage Noise	4.5 nV/√Hz (@ 50 MHz, 40 dB gain)	5.5 nV/√Hz (@ 50 MHz, 20 dB gain)	Intregated Input Noise	450 μV peak-peak (@ 40 dB gain)	600 μV peak-peak (@ 20 dB gain)	Input Bias Current	10 pA	Input Offset Voltage	500 μV typ.	Input Voltage Drift	5 μV/°C	Output	Output Impedance	50 Ω (terminate with 50 Ω load for best performance)	Output Voltage	± 1 V (@ 50 Ω load, for linear amplification)	Max. Output Current	60 mA	Output Offset Trimmer Range	± 100 mV	Slew Rate	600 V/μs (@ 20 dB, 50 Ω load) 1,100 V/μs (@ 40 dB, 50 Ω load)	Power Supply	Supply Voltage	± 15 V	Supply Current	± 70 mA typ. (depends on operating conditions, recommended power supply capability min. ± 150 mA)
	<i>Test Conditions</i>	<i>V_s = ± 15 V, T_a = 25°C</i>																																													
Gain	Gain	20/40 dB switchable																																													
	Gain Accuracy	± 0.2 dB																																													
Frequency Response	Lower Cut-Off Frequency (-3 dB)	DC/1 Hz switchable																																													
	Upper Cut-Off Frequency (-3 dB)	200 MHz																																													
	Rise/Fall Time (10% - 90%)	1.8 ns																																													
Input	Input Impedance	1 MΩ 15 pF																																													
	Input Voltage Noise	4.5 nV/√Hz (@ 50 MHz, 40 dB gain)																																													
		5.5 nV/√Hz (@ 50 MHz, 20 dB gain)																																													
	Intregated Input Noise	450 μV peak-peak (@ 40 dB gain)																																													
		600 μV peak-peak (@ 20 dB gain)																																													
	Input Bias Current	10 pA																																													
Input Offset Voltage	500 μV typ.																																														
Input Voltage Drift	5 μV/°C																																														
Output	Output Impedance	50 Ω (terminate with 50 Ω load for best performance)																																													
	Output Voltage	± 1 V (@ 50 Ω load, for linear amplification)																																													
	Max. Output Current	60 mA																																													
	Output Offset Trimmer Range	± 100 mV																																													
	Slew Rate	600 V/μs (@ 20 dB, 50 Ω load) 1,100 V/μs (@ 40 dB, 50 Ω load)																																													
Power Supply	Supply Voltage	± 15 V																																													
	Supply Current	± 70 mA typ. (depends on operating conditions, recommended power supply capability min. ± 150 mA)																																													

200 MHz High Input Impedance Voltage Amplifier

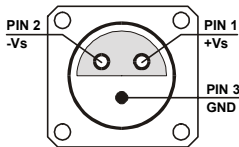
Specifications (continued)		
Case	Weight Material	200 g (0.5 lbs) AlMg4.5Mn, nickel-plated
Temperature Range	Storage Temperature Operating Temperature	- 40 ... + 100 °C 0 ... + 60 °C
Absolute Maximum Ratings	Power Supply Voltage Input Voltage Transient Input Voltage	± 20 V ± 5 V 200 V (out of a 200 pF source)
Connectors	Input Output Power Supply	BNC BNC LEMO series 1S, 3-pin fixed socket Pin 1: + 15V Pin 2: - 15V Pin 3: GND
		

200 MHz High Input Impedance Voltage Amplifier

Dimensions

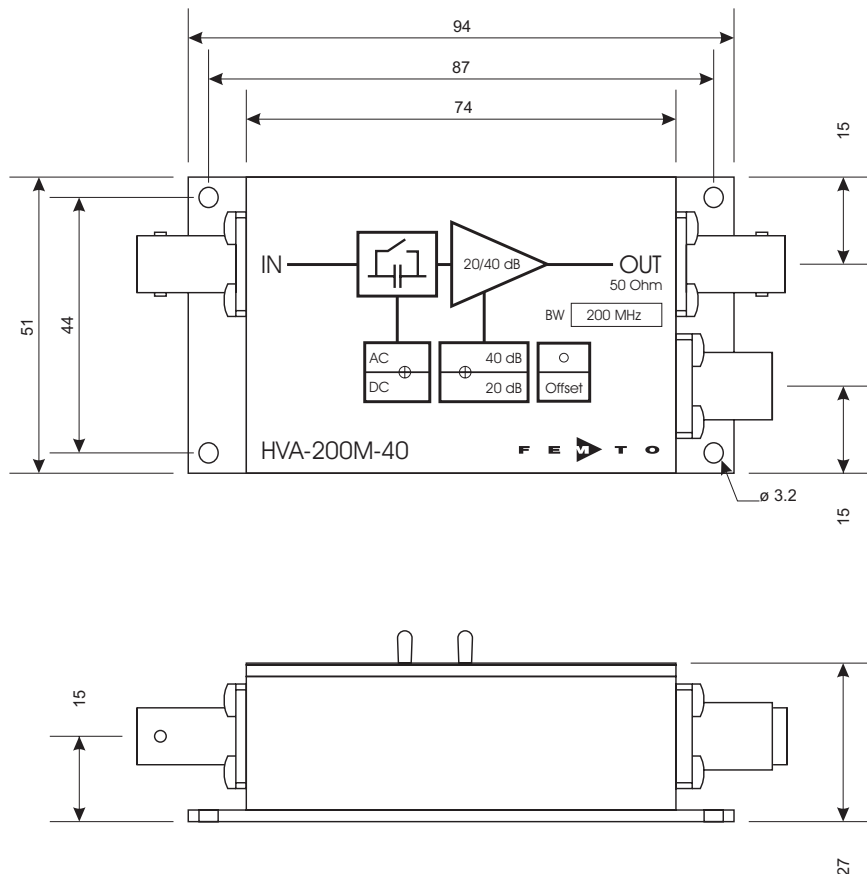

all measures in mm unless otherwise noted

DZ_HVA-200M-40_R2

FEMTO Messtechnik GmbH
 Klosterstr. 64
 D-10179 Berlin · Germany
 Tel.: +49-(0)30-280 4711-0
 Fax: +49-(0)30-280 4711-11
 e-mail: info@femto.de
 http://www.femto.de

Specifications are subject to change without notice. Information furnished herein is believed to be accurate and reliable. However, no responsibility is assumed by FEMTO Messtechnik GmbH for its use, nor for any infringement of patents or other rights granted by implication or otherwise under any patent rights of FEMTO Messtechnik GmbH. Product names mentioned may also be trademarks used here for identification purposes only.
 © by FEMTO Messtechnik GmbH
 Printed in Germany