

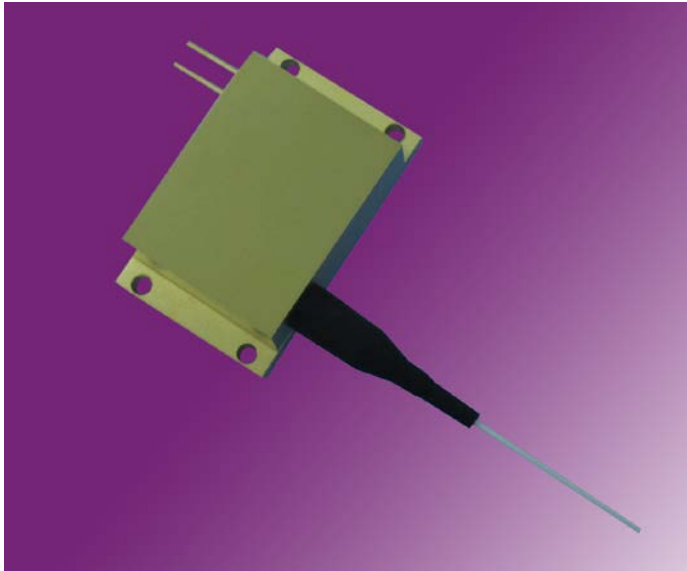

## T-Series High Power Laser Diode Module

M9XX±10-35-F105/15-T4S

M9XX±10-40-F105/22-T4S



### Features:

High output Power: 35W, 40W

105µm core multimode optical fiber

0.15NA,0.22NA

Fiber laser feedback protection

915nm, 940nm and other 9XX wavelength

Electrically isolated housing

### Applications:

Laser pumping

Medical use

Material processing

### 915nm Characteristics (25°C, 35W)

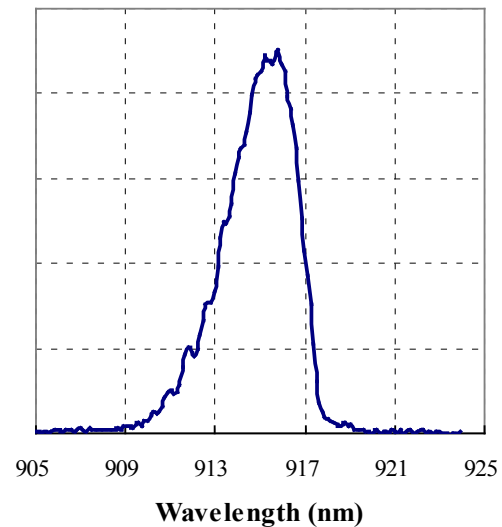
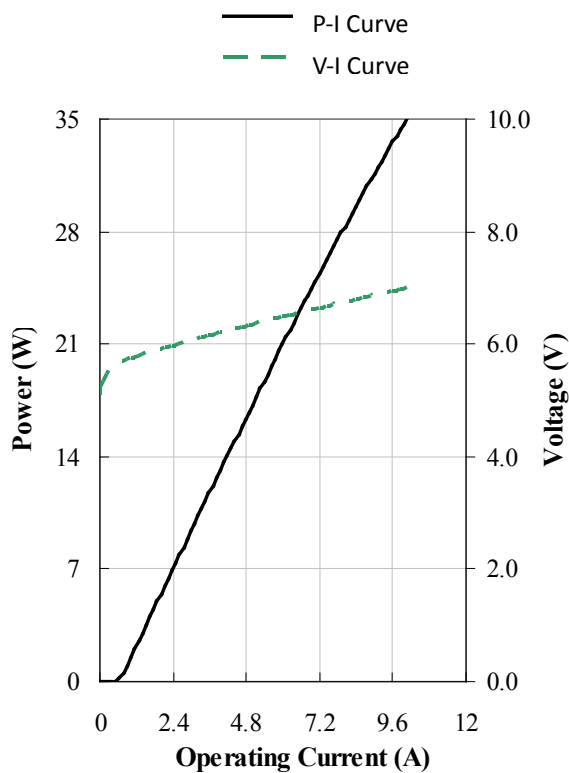

## Typical Device Performance (25°C)

Parameter	Symbol	Typical		Unit	
		M9XX±10-35-F105/15-T4S	M9XX±10-40-F105/22-T4S		
Optical	CW Output Power	$P_{op}$	35	40	W
	Center Wavelength	$\lambda_c$	915, 940 and other 9XX wavelength, ±10		nm
	Spectral Width (90% of Power)	$\Delta\lambda$	<6.0		nm
	Wavelength Shift with Temperature	$\Delta\lambda/\Delta T$	0.35		nm/°C
	Feedback Protection (1030-1100nm)	FP	>40		dB
Electrical	Threshold Current	$I_{th}$	0.65		A
	Operating Current	$I_{op}$	10.5	12	A
	Operating Voltage	$V_{op}$	6.8	6.9	V
	Slope Efficiency	$\eta_{es}$	3.6		W / A
	Power Conversion Efficiency	$\eta_{ep}$	48		%
Fiber	Fiber Core Diameter	$d_{core}$	105		μm
	Fiber Cladding Diameter	$d_{clad}$	125		μm
	Fiber Buffer Diameter	$d_{buffer}$	250		μm
	Numerical Aperture	NA	0.15	0.22	-
	Fiber Length	L	1.0		m

## Other Parameters

Parameter	Operating Temperature /°C	Operating Relative Humidity /%	Storage Temperature /°C	Storage Relative Humidity /%	Lead Soldering Temperature, 10s max/°C
Min	10	-	-20	-	-
Max	40	75	80	90	250

## Package Dimensions (mm)

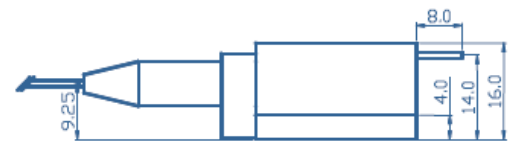
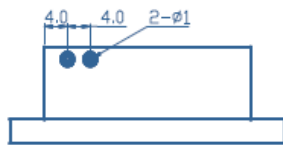

Pin	Function
1	Laser(+)
2	Laser(-)

