



Electro Optical Components, Inc.

5460 Skylane Boulevard, Santa Rosa, CA 95403

Toll Free: 855-EOC-6300

www.eoc-inc.com | info@eoc-inc.com



785nm 600mW Laser Diode Module

R785±0.5-600mWW-14SBTF-TG

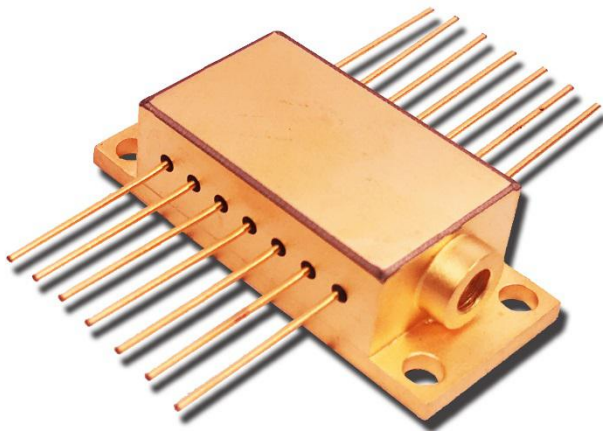

Feature	
Output power:	600mW
Wavelength:	785±0.5nm
Current range:	0.4~1.3A
Temperature range:	15~30°C
Application	
Spectrum	
Biology analysis	

785nm 600mW Characteristics (25°C)

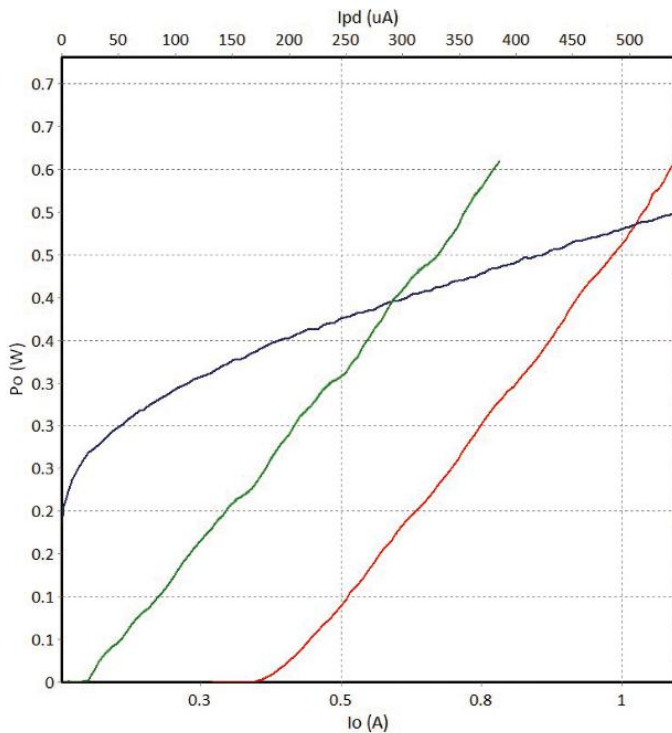

785nm P-I-V graph

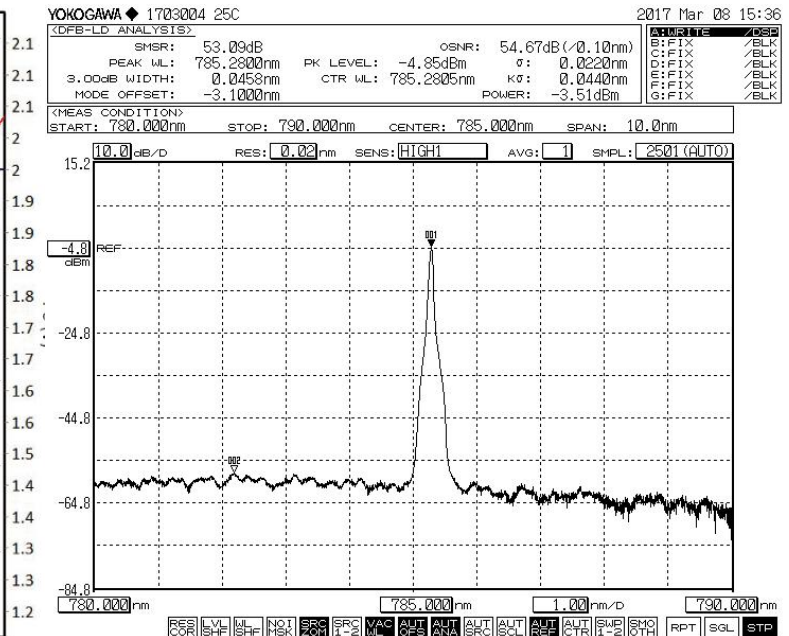

785nm Laser spectrum

Parameters

Parameter	Operating Temperature /°C	Operating Relative Humidity /%	Storage Temperature /°C	Storage Relative Humidity /%	Lead Soldering Temperature (max)/°C
Min	10	-	-20	-	-
Max	30	75	70	90	250(10Sec.)

Typical Device Performance(25°C)

Parameter	Symbol	Typical Value	Unit	
		R785±0.5-600mWW-14SBTF-TG		
Optical	CW Output Power	P_{op}	600	mW
	Center Wavelength	λ_c	785±0.5	nm
	Spectral Width	$\Delta\lambda$	≤0.1	nm
	Temperature drift of wavelength	$\Delta\lambda / \Delta T$	0.01	nm/°C
Electrical	Threshold Current	I_{th}	0.36	A
	Operating Current	I_{op}	1.09	A
	Operating Voltage	V_{op}	2.0	V
	Slope Efficiency	η_{es}	0.8	W/A
	PD Parameter	I_{mo}	<2000	μA
	Thermistor	R_t	10±5%/3450	kΩ/β(25°C)
	TEC max Current	I_{max}	2.5	A
	TEC max Voltage	V_{max}	6.3	V

Package Dimensions (mm)

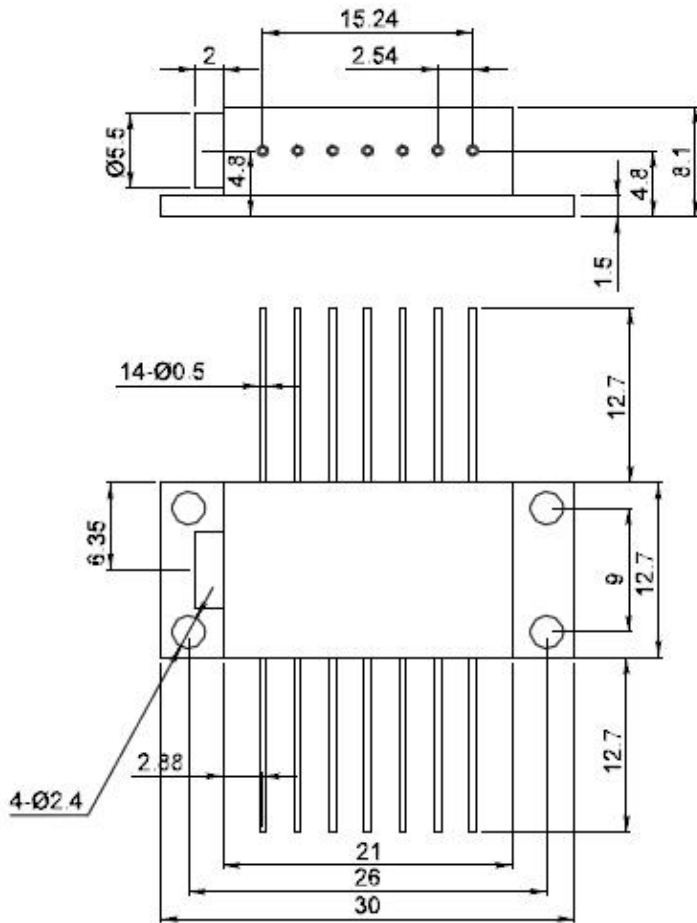

Pin	Function	Pin	Function
1	TEC(+)	8	--
2	Thermistor	9	--
3	PD(P)	10	Laser(+)
4	PD(N)	11	Laser(-)
5	Thermistor	12	--
6	--	13	Case
7	--	14	TEC(-)